

# Cutting and fitting instructions garage door floorseal 'GDS'

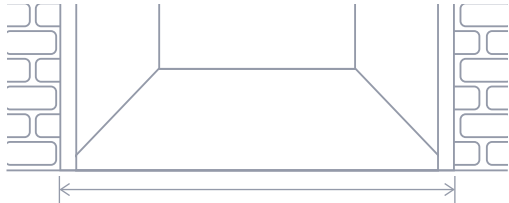

## TOOLS YOU MAY NEED

- Tape measure
- Pencil
- Fine tooth saw, hacksaw, power saw or similar
- Scissors, pliers, box cutters
- Drill



1) Remove old seal (if applicable). Measure the overall width of the garage door opening (brick to brick) and trim if needed. Remember you will have to cut the seal to fit around the door frame. Ensure the surface is clean, dry, and free of dust and grease. \* We recommend following any specific surface preparation instructions on your selected adhesive.

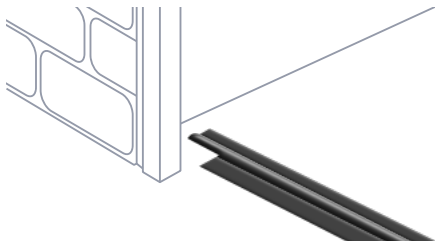

2) Position the ends of the seal against the door frame to determine how to cut the recess at each end of the seal. Mark with a pencil where to make the cut on the seal, using either a hacksaw, razor, knife or cutters.

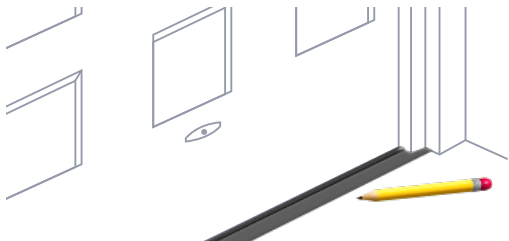

3) Position the floor seal against the INSIDE of the garage door while it is closed, and slide the thinnest part of the seal under the door. Once you are satisfied with the position, use a pencil to mark along the length of the seal. Then, open the door and carefully mark along the outside edge of the seal.

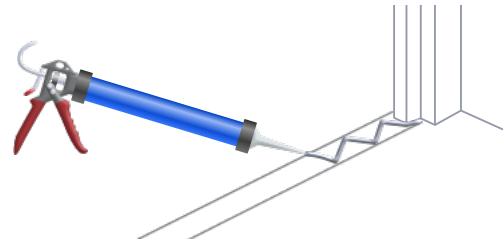

4) Using the polyurethane adhesive and applicator gun, apply a line of roughly 1cm inside the marked lines, then apply a zig-zag line of adhesive in between.

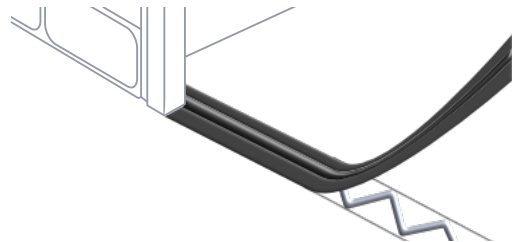

5) Start from one end, and press the floor seal down onto the sealant working your way along the length of the seal. Clean any sealant residue and allow to set for 24 hours.

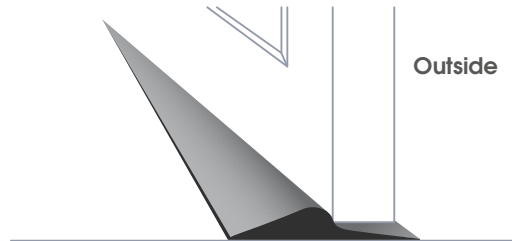

6) (Optional) You may choose to install metal fixings (particularly where vehicles will be driving over) to ensure a secure fix.

## BRUSH STRIPS & SEALING SYSTEMS

Formseal Limited  
Unit 5  
Douglas Park Opal Way  
Stone - ST15 0YJ  
United Kingdom

+ 44 (0) 1785 284808  
sales@formseal.co.uk  
www.formseal.co.uk